

AUGUST®

User Manual

SE10



August International Ltd
Rawmec Business Park
Hoddesdon EN11 0EE
United Kingdom
T: +44(0) 845 250 0586
(Carrier Rates Apply)
E: service@augustint.com

EU Distributor:
Daffodil Germany GmbH
Bayernstr. 10
D-30855 Langenhagen
Germany
T: +49 (0) 511 97812978

www.augustint.com

EN Portable CD and MP3 Player

FR Lecteur CD et MP3 portable

DE Tragbarer CD- und MP3-Player

IT Lettore CD e MP3 portatile

ES Reproductor de CD y MP3 portátil

PL Przenośny odtwarzacz CD i MP3

RU Портативный проигрыватель CD и Mp3

User Manual

Thank you for purchasing August SE10B Portable CD & MP3 Player. This user manual is designed to familiarize you with all the features of this device. Please take the time to read this user manual carefully, even if you are already familiar with a similar product.

Safety

To ensure the safety of you and others, please read the Safety Instructions before using this device. Please do not disassemble the SE10B, it can be unsafe and will invalidate the manufacturer's warranty.

Disposal

Please ensure the product and accessories are disposed of in compliance with the WEEE (Waste Electrical and Electronic Equipment) Directive and any other regulations applicable to your country. Always check with the environment agency and any other relevant authorities for current disposal regulations.

Declaration of Conformity

The Declaration of Conformity can be found on our website at <http://augustint.com/en/declaration/>

Customer Service

You can contact us by phone on: +44(0)845 250 0586 (Carrier Rates Apply) or by email at: service@augustint.com should you require further technical support or customer service.

1. Safety Instructions

Storage and Use

	Do not store or use this device in extreme temperatures.		Do not store or use this device in wet or damp environments.
	Do not expose this device to dust, oil or smoke.		Do not drop or strike this device.
	When transporting this device store securely to avoid impact damage.		Do not scratch this device with sharp objects.

Maintenance

Please unplug all leads before cleaning this device.

	Wipe the device and buttons with a soft cloth.		Never wipe this device with an abrasive cloth or apply detergent, alcohol or chemical based cleaning products.
--	--	--	--

2. Main Features

- Stereo Speakers & 3.5mm Audio Jack
- Equaliser with 5 Sound Modes
- Adjustable Playback Speed
- Built-in Rechargeable Battery
- Electronic Skip Protection

3. Box Contents

SE10B	USB Charging Cable	User Manual	3.5mm Audio Cable	Earphone

4. Part Names and Functions

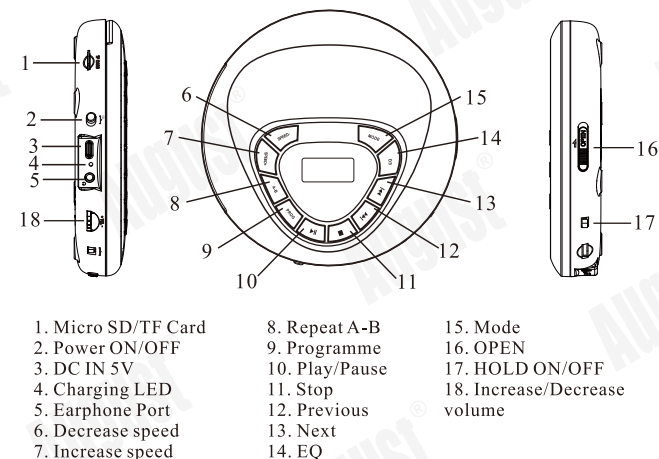

5. Operation

5.1 Power

Charging:

You can use any charger that supports USB 2.0.

It will take around 4 hours to fully charge the player. When the battery is being charged, the LED indicator will be red. Once the player has fully charged, the LED indicator will turn green.

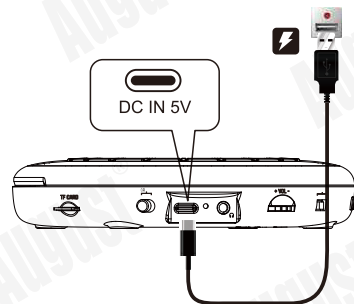

Power On:

The power switch is located on the side. Please toggle it to ON. When a disc has played to the end or there is no disc, the SE10B will enter a standby mode after 20 seconds. Please press the PLAY button again to restart the player.

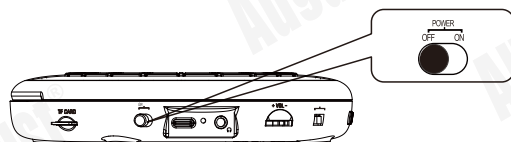

Power Off:

There are two ways to turn off the player:

1. Please toggle the power switch to OFF position if the player will no longer be used for a long time;
2. The player will enter a standby mode by pressing the STOP button.

Note: Please turn the power switch to OFF after use.

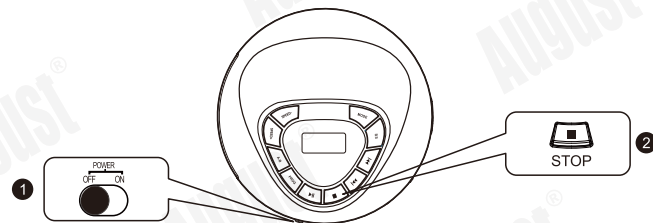

5.2 Music Source

CD:

Push the OPEN button to the right to open the door. Insert your index finger into the centre hole of the disc and take the edge of the disc with your thumb. Insert the disc upwards and press the disc gently until it clicks into place. Close the disc door gently, otherwise the player will not read the disc.

Note: The SE10B is only compatible with CD, CDR, MP3 & HDCD.

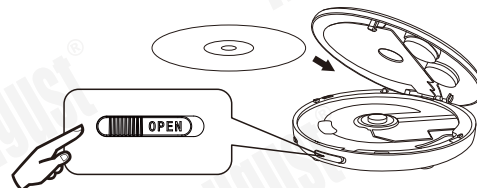

Micro SD/ TF Card:

Insert the Micro SD/TF card with the arrow pointing toward the slot, and carefully slide it into the slot until it clicks into place. Turn on the player, then press and hold the Play/Pause button until 'Sd' displays.

Note: The SE10B is compatible with MP3 format in Micro-SD Card mode only.

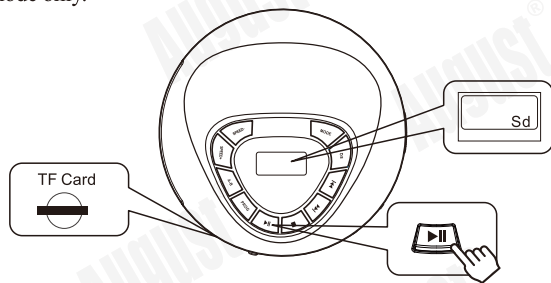

5.3 Repeat

Each time the MODE button is pressed, the order of the tracks played will be as follows: Repeat Current Song Only (REP1), Repeat all (ALL), Shuffle (SHUF), Preview (INTRO) - only 10 second per track will be played in this mode.



5.4 A-B Repeat

This function allows you to select a specific audio section to repeat. This is particularly useful when learning languages or instruments.

When a CD is playing, press the <A-B> button at the beginning of the section you wish to repeat. Press <A-B> again at the end of the section. The CD player will repeat the selected section.

To resume normal CD play, press <A-B> once more.

5.5 Programme

Press the PROG button to enter the programming mode when the play stops, press the PREVIOUS or NEXT button to select the track you want to program, press PROG again to confirm the programming.

Up to 30 tracks can be programmed in this mode. After that, press the PLAY button to enter the programming play mode. Press the STOP button directly to enter the stop mode to cancel or reprogram.



5.6 Volume

The volume dial is located on the side of the SE10B. Rotate it to the left or right to decrease or increase the volume. Please listen to music at an appropriate volume to avoid damaging your hearing.

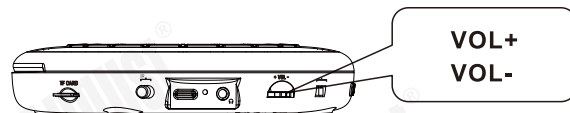

5.7 Equalizer

Press the EQ button to cycle through various sound modes. There are a total of 5 modes: Bass, Pop, Jazz, Rock & Classic.



5.8 Hold

After playback mode and EQ have been setup, you can toggle the Hold switch to On to prevent any settings from being changed.

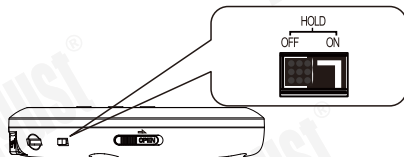

5.9 Bookmark

ON: The player will play the most recently played track on the CD.

Note: In Micro-SD Card mode, the player will resume playback from 5 seconds before the Bookmark point.

OFF: The player will restart playing on the first track of the CD. Press and hold the PROG button to turn this function on or off. ON or OFF will be displayed on the screen. This function is turned on by default.



Note: To use the Bookmark function, follow method 2 to power off the device to enter standby mode. If the Power Switch is toggled to OFF, all settings will be erased.

6. Troubleshooting

Problem: Cannot read disc.

Causes	Solution
CD is installed incorrectly.	1. Make sure the label side of the disc is facing upwards. 2. Ensure the disc is fully into the place.
CD is dirty or damaged.	1. Make sure the disc is not scratched or damaged. 2. Wipe the disc gently from the centre to the edge with a clean, soft cloth. 3. Try another disc to check if the disc is faulty.
Disc reader is dirty.	Wipe the lens gently with a cotton swab.

Problem: Cannot charge battery.

Causes	Solution
There is no current at power outlet.	Make sure that the power outlet is turned on.
The plug is not plugged in correctly.	Make sure that the plugs of the power cord are connected properly.
The charger is damaged.	Please try another USB charging cable.
SE10B is damaged.	Please contact Customer Service.

Problem: The player cannot be turned on.

Causes	Solution
Switch is not turned on.	Flick to power switch to ON.
No battery	Charge the battery.
SE10B is damaged	Please contact Customer Service.

7. Specification

Size	140x28mm
Weight	230g
Power source	DC 5V/1A Type C
Operating voltage	4.2V
Power consumption	~1.5W
Battery	Lithium-ion polymer 4.2V/1400mAh
Sampling frequency	44100 Hz
Frequency response	20 Hz-20000 Hz
Supported disc formats	CD, CDR, HDCD, Mp3
Shockproof time	CD: 100 seconds/MP3: 180 seconds+

8. Warranty

This product is guaranteed for 12 months from the date of the original purchase. In the unlikely event of any defect arising due to faulty materials or workmanship, the unit will be either replaced or repaired free of charge (where possible) during this period. An alternative product will be offered in case the product is no longer available or repairable.

This warranty is subject to the following conditions:

- The warranty is only valid within the country where the product is purchased.
- The product must be correctly installed and operated in accordance to the instructions given in this user manual.
- The product must be used solely for domestic purposes.
- The warranty only covers the main unit, and does not cover the accessories.
- The warranty does not cover the damage caused by misuse, negligence, accident and natural disaster.
- The warranty will be rendered invalid if the product is resold or has been damaged by inexperienced repairs. The manufacturer disclaims any liability for incidental or consequential damages.
- Please consult our customer adviser before returning any product; we are not responsible for any unexpected product returns.
- Any faulty product must be kept and returned in the original packaging with all the accessories and the original copy of the purchase receipt.

The warranty is in addition to, and does not diminish, your statutory or legal rights.

Customer Service:

Telephone: +44 (0) 845 250 0586 (Carrier Rates Apply)

Email: service@augustint.com

This product is in compliance with the essential requirements and other relevant provisions of Directive 2014/53/EU. The Declaration of conformity may be consulted online at <http://www.augustint.com/en/declaration>



Industry Canada Statement

This device complies with Industry Canada license-exempt RSS standard(s). Operation is subject to the following two conditions: (1) this device may not cause interference, and (2) this device must accept interference, including interference that may cause undesired operation of the device.

Note: This equipment has been tested and found to comply with the limits for a Class B digital device, pursuant to part 15 of the FCC Rules. These limits are designed to provide reasonable protection against harmful interference in a residential installation. This equipment generates uses and can radiate radio frequency energy and, if not installed and used in accordance with the instructions, may cause harmful interference to radio communications. However, there is no guarantee that interference will not occur in a particular installation. If this equipment does cause harmful interference to radio or television reception, which can be determined by turning the equipment off and on, the user is encouraged to try to correct the interference by one or more of the following measures:

- Reorient or relocate the receiving antenna.
- Increase the separation between the equipment and receiver.
- Connect the equipment into an outlet on a circuit different from that to which the receiver is connected.
- Consult the dealer or an experienced radio/TV technician for help.

No Unauthorized Modifications: Do not make any changes or modifications to this product without the prior express written approval of August International Ltd. Any changes or modifications made without express written approval could void the user's authority to operate this product.



For details of further relevant technical standards, please contact us at the address above.